



93 Waterloo Terrace

Ashton-On-Ribble, Preston, PR2 1DA

Offers Over £125,000



Welcome to this charming 2-bedroom mid-terraced property located in the ever-popular area of Ashton-on-Ribble. Situated on Waterloo Terrace, this well-presented home offers a fantastic opportunity for first-time buyers, investors, or anyone looking to enjoy the convenience of a central location with plenty of character.

Step inside to find two generous reception rooms, perfect for use as a living room and dining area or a flexible work-from-home space. The modern fitted kitchen to the rear offers ample storage and access to a private rear yard, ideal for outdoor seating or storage.

Upstairs, the property boasts two well-proportioned bedrooms and a family bathroom, all tastefully decorated and ready to move into.

Located within easy reach of local amenities, excellent transport links, and Preston city centre, this home combines comfort, practicality, and location.

Don't miss your chance to view this fantastic property – early viewing is highly recommended!



Ground Floor

Hallway

Lounge 14'11" x 10'10" (4.56m x 3.31m)

Dining Room 17'9" x 11'6" (5.43m x 3.51m)

Kitchen 10'5" x 8'2" (3.18m x 2.5m)

First Floor

Landing

Bedroom One 14'7" x 12'5" (4.47m x 3.81m)

Bedroom Two 12'9" x 8'7" (3.89m x 2.62m)

Bathroom 10'9" x 7'11" (3.3m x 2.42m)

Area Map



Floor Plans

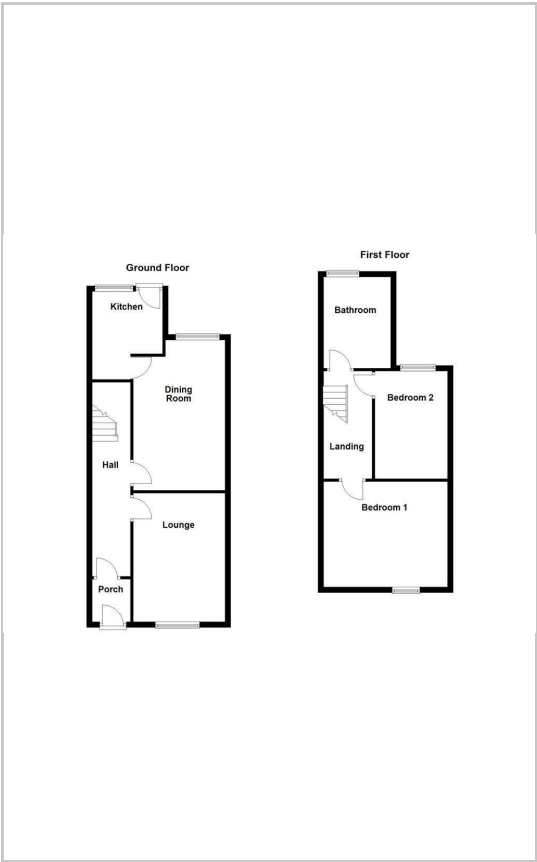

Energy Efficiency Graph

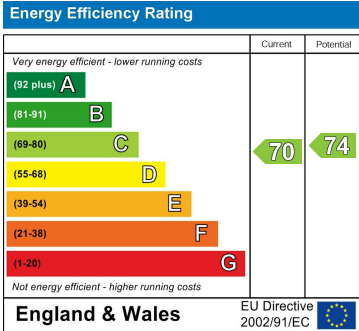

These particulars, whilst believed to be accurate are set out as a general outline only for guidance and do not constitute any part of an offer or contract. Intending purchasers should not rely on them as statements of representation of fact, but must satisfy themselves by inspection or otherwise as to their accuracy. No person in this firms employment has the authority to make or give any representation or warranty in respect of the property.